

M Series Duct UVnano Filter Box Installation/User Guide

* UVnano is a compound word derived from the words UV and its unit nanometer.

Be sure to read the safety precautions before using the product. These precautions are intended to protect the user while preventing property loss. After reading the installation/user guide, keep it in a location where user can access it anytime.

WARNING

Not following the instructions could result in death or severe injury to the user.

CAUTION

Not following the instructions could result in injury to the user or property damage.

Things to Remember

- Since the installation requires specialized skills, the product must be installed by a service centre or an installation centre approved by LG electronics. (If installation is carried out by a person without an installation license, that person is responsible for all problems related to the installation, in which case LG Electronics shall provide no free maintenance or repair service.)
- After the installation is completed, be sure to show the customer that the product functions normally and has no problems.
- Before installation, be sure to read the Installation/User guide.

WARNING

- This appliance can be used by children aged from 8 years and above and persons with reduced physical, sensory or mental capabilities or lack of experience and knowledge if they have been given supervision or instruction concerning use of the appliance in a safe way and understand the hazards involved. Children shall not play with the appliance. Cleaning and user maintenance shall not be made by children without supervision.
- This appliance is not intended for use by persons (including children) with reduced physical, sensory or mental capabilities or lack of experience and knowledge, unless they have been given supervision or instruction concerning use of the appliance by a person responsible for their safety. Children should be supervised to ensure that they do not play with the appliance.
- The appliance shall be disconnected from its power source during service and when replacing parts.
- This appliance contains a UV-C lamp, do not stare at the light source.
- Read the maintenance instructions before opening the appliance.
- Unintended usage of the appliance or damage to the housing may result in the escape of dangerous UV-C radiation. UV-C radiation may, even in small doses, cause harm to the eyes and skin.
- Appliances that are obviously damaged must not be operated.

WARNING

- Before opening doors and access panels bearing the ultraviolet radiation hazard symbol for the conducting user maintenance, it is recommended to disconnect the power.
- UV-C barriers bearing the ultraviolet radiation hazard symbol should not be removed.
- Do not operate UV-C lamps outside of the appliance.
- The appliance must be disconnected from the supply before replacing the UV-C lamp.
- Prior to cleaning or other maintenance, the appliance must be disconnected from the supply mains.

* UV model name : LTPL-G35U275GS-TWA

CAUTION

- Do not install the unit in potentially explosive atmospheres.
- Only qualified service personnel can carry out the repair work, cleaning and maintenance.

1 UVnano Filter Box Components

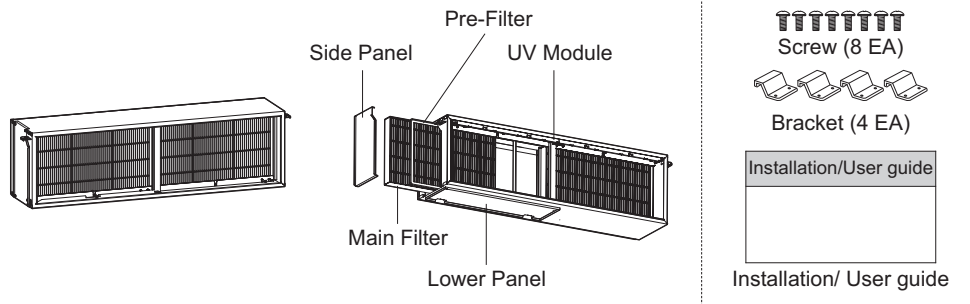

* Pre-Filter : Pre-Filter : Reusable after washing with water, Main Filter : Replacement recommended within 3-6 months of use.

NOTE

- Applicable only to the indoor manufactured after October 2021.
- Only available on Standard III wired remote control (Standard III wired remote controller model name : PREMTB100, PREMTBB10)
- Pre-Filter : Reusable after washing with water, Main Filter : Replacement recommended within 3-6 months of use.
- * Possible to check the accumulated usage time of Main Filter through Standard III wired remote controller.
- * When replacing Main Filter, additionally checking the status of Pre-Filter is recommended.
- The feature can be changed according to the type of model.

2 How to install the UVnano Filter Box on the indoor Unit

(1) Preparation of the indoor unit.

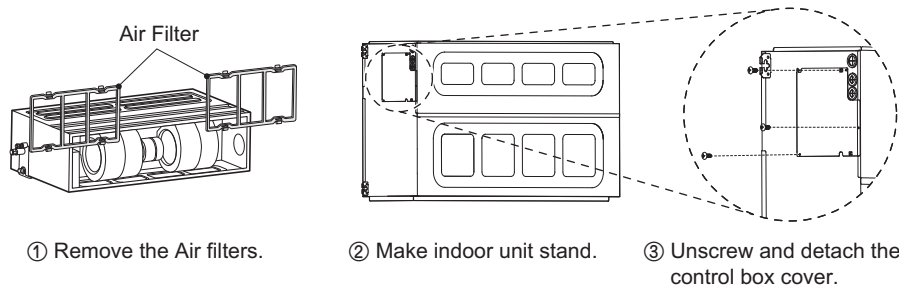

(2) Preparation of the UVnano Filter Box

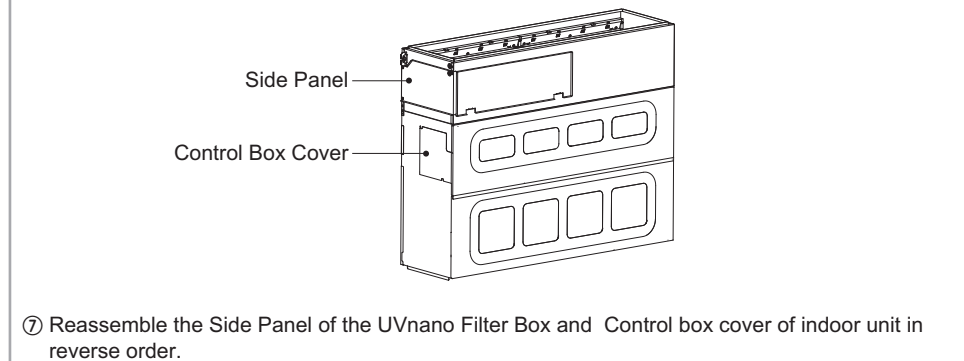
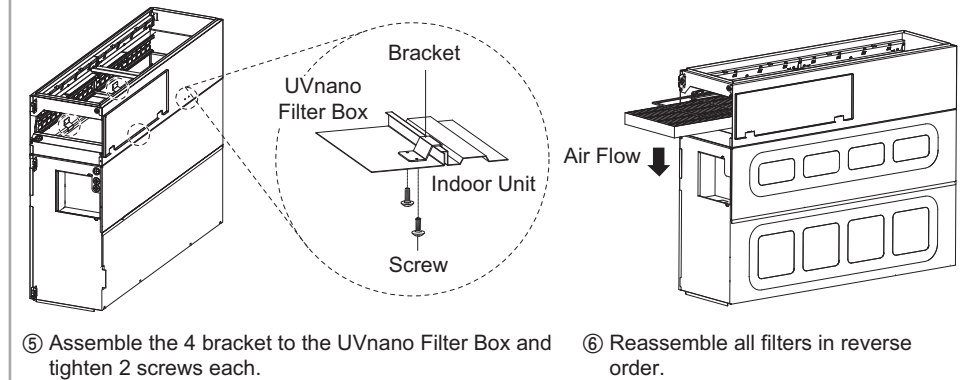
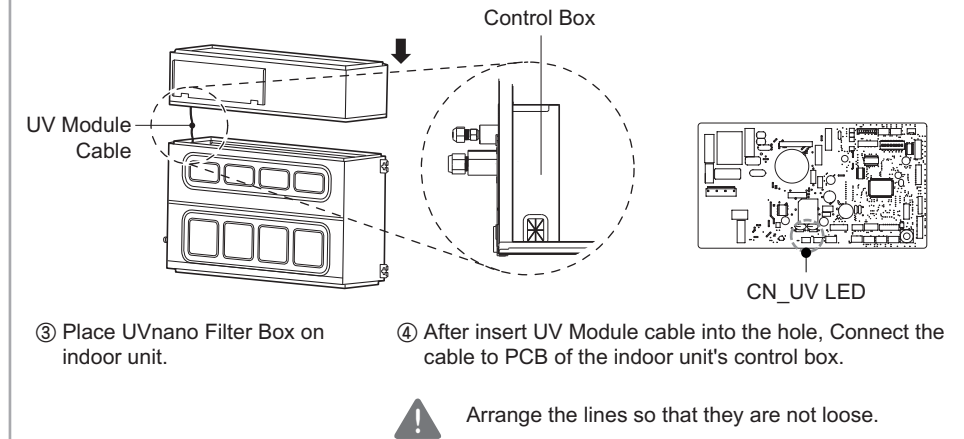
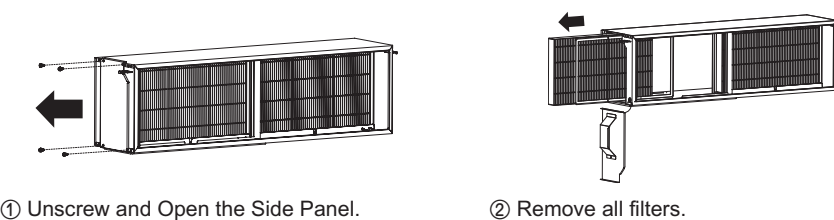

3 Installer Setting

At the field, select this function when UVnano Filter Box newly installed to the indoor unit or when UVnano Filter Box is removed.

- Set the following setting values by pressing <, > button.

Installer	Back	OK	OK
Indoor unit physical address			
Indoor temperature master/slave			
Indoor unit physical address			
Individual IDU control			
UVnano			
Filter Box			

Function	Value
UVnano	Not install / Install
Filter Box	

CAUTION

Make sure to set the 2 functions by proceeding with installer mode.
If you set incorrectly, the air conditioner may malfunction.

4 User Setting

UVnano is a function that sterilizes fans or filters using UV LEDs at regular intervals during air conditioning operation.

- Set the following setting values by pressing <, > button.

Function	Back	OK	OK
Wi-Fi Pairing			
Advanced fan speed "Auto"			
My favorite temperature			
UVnano			

Function	Value
UVnano	Not use / Use

5 Position of Suspension Bolt

Install the unit above the ceiling correctly.

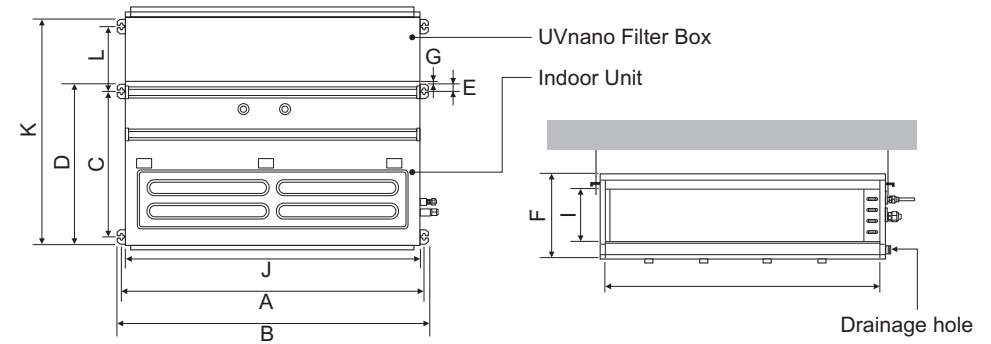

Unit: mm

Dimension	A	B	C	D	E	F	G	H	I	J	K	L
Chassis name												
M1	933.4	971.6	619.2	700	30	270	15.2	858	201.4	900	980	279
M2	1283.4	1321.6	619.2	700	30	270	15.2	1208	201.4	1250	980	279
M3	1283.4	1321.6	619.2	700	30	360	15.2	1208	291.4	1250	980	279

6 Position of Maintenance Hole

Install the lower or the side maintenance hole to maintain the filter when installing the UVnano Filter Box. Refer to the indoor unit installation manual of installation intervals.

The place shall be able to maintain the unit as the figure.

Unit: mm

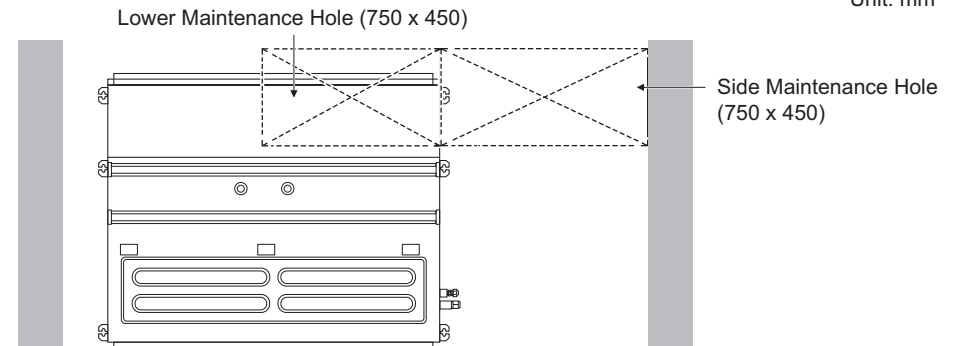

7 How to Maintain of the Filter

⚠ CAUTION

- When removing the service Panel, Make sure the product is turned OFF.
- Only qualified service personnel can carry out replacing and maintaining filter.

Side Service

1. Loosen 4 screw and Open the Side Panel.
2. Detach the side panel and maintain the filters.
3. Reassemble in reverse order.

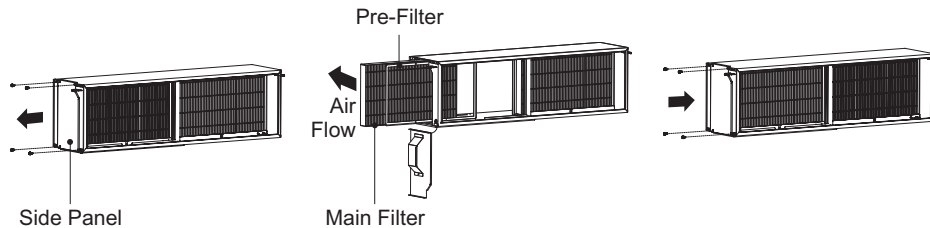

Lower Service

1. Loosen 4 screw from lower panel.
2. Detach the lower panel and maintain the filters.
3. Remove the fall arrest bracket.

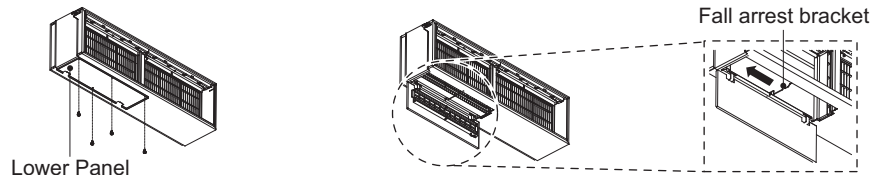

4. Maintain the filters.
5. Reassemble in reverse order.

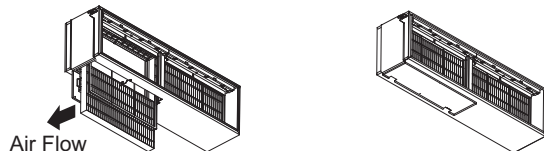

Pre-Filter

- Reusable after washing with water.
- Replacement recommended after washing 2-3 times.

1. Cleaning dirt from Pre-Filter using Vacuum cleaner or washing with water.
 - If dirt is conspicuous, wash with a neutral detergent in lukewarm water.
 - If hot water (50 °C or more) is used, it may be deformed.
2. After washing with water, dry well in the shade.
 - Do not expose the Pre-Filter to direct sunlight or heat from a fire when drying it.

Never use any of the followings :

Water hotter than 40 °C could cause deformation and or discoloration.
Volatile substances could damage the surfaces of the air conditioner.



8 How to Set E.S.P

Set the E.S.P. of the product by referring to P-Q Curve. (Last Page)